

TECHNICAL DATA SHEET

BBD1131CNTF

MCB 13A Single Pole 1P1E, DIN Rail, 6kA, Cable/Pin-typebusbar

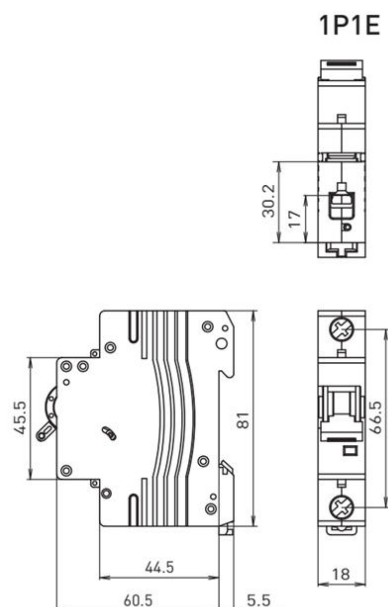

Unit: mm

Technical Specification

Reference Standard	IEC60898-1
Electrical properties	
Pole	1P, 3P
Rated current(In)	13
Rated voltage(Ue)	240~[1P] / 415V~[3P]
Rated conditional residual operating current (IΔn)	-
Rated frequency	50/60Hz
Rated impulse withstand voltage(1.2/50)(Uimp)	4,000V
Rated short-circuit breaking capacity[Icn]	6kA
Mechanical properties	
Mechanical endurance	20,000 cycles
Electrical endurance	4,000 cycles
Protection degree	IP20
Operating temperature	-10°C~60°C
Other properties	
Terminal connection type	Cable/Pin-typebusbar
Connections	1mm ² to 25mm ² for Cu conductors
Tightening torque	2.0Nm
Status display	On: Red
	Off,Trip: Green

Disclaimer: All information contained here is given according to our specifications and best knowledge and can be changed without further notice.
This documentation is not intended as a substitute for and is not to be used for determining suitability or reliability of these products for specific user applications.
It is the duty of any such user or integrator to perform the appropriate and complete risk analysis, evaluation and testing of the products with respect to the relevant specific application or use thereof.
Neither Panasonic Middle East and Africa PZ nor any of its affiliates or subsidiaries shall be responsible or liable for misuse of the information contained herein.