

Panasonic

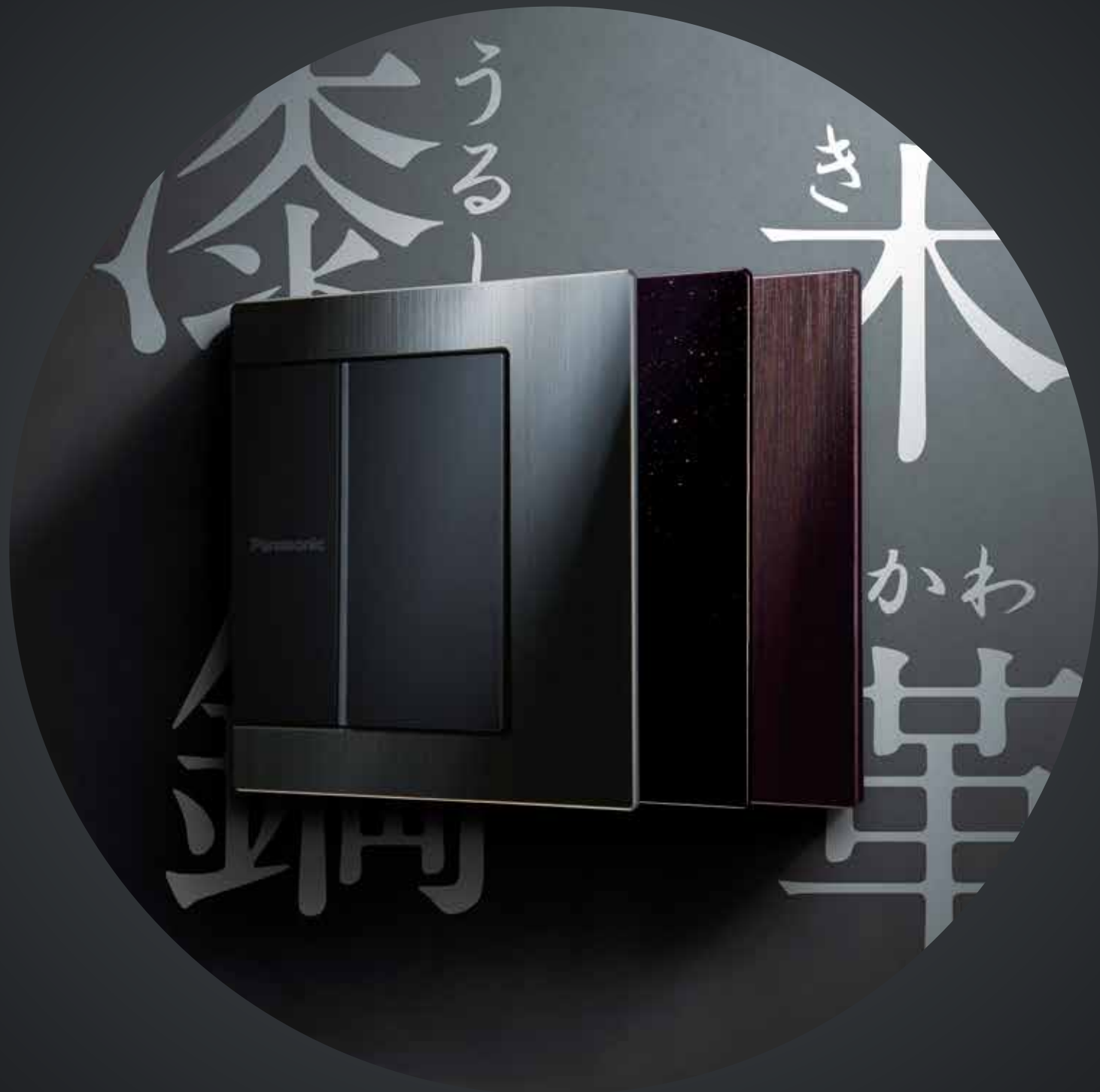

FLATIMA

SERIES

تتميز سلسلة مفاتيح باناسونيك المتطورة بلوحة خاصة للقوة والمظهر الراقى الذي يضيف لمسة من الأناقة إلى الحياة اليومية.

High-end Panasonic switch series featuring special panel for strength and a refined appearance that adds a touch of elegance to everyday life.



FLATIMA BS-TYPE
SERIES

سطح متطور بتصميم فائق النحافة.

SOPHISTICATED SURFACE WITH A SUPER-SLIM DESIGN

Ideal asymmetric design using 2mm-thick, high-quality aluminum plate.



أحدث آلية تبديل مقاومة للحرارة وسهلة الاستخدام

HEAT-RESISTANT, EASY-TO-USE LATEST SWITCH MECHANISM

On/Off with just a soft push of the switch.
Built for trouble-free operation.

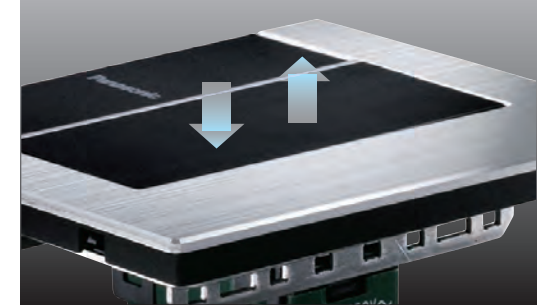

تضمن ميزات الموثوقية العالية السلامة

HIGH RELIABILITY FEATURES ENSURE SAFETY

Complies with requirements of the Saudi Arabian Standards Organization (SASO)



علامة الجودة الإماراتية
Emirates Quality Mark

New
漆 Urushi
 — The Japanese Lacquer —



The brilliant technical fusion of Panasonic's century old history in wiring devices with "Aizu Nuri" by URUSHI (Japanese Lacquer) that originated 400 years back. Hand painted URUSHI is not only beautiful but also good for waterproofing and preservation from decay.

New
木 / **革**
 Wood / Leather



Japan's latest ink-jet printing technology for natural texture and comfortable touch. Perfect to match with a wide variety of interior design styles.

Model No[Plate] *Special order : Made by your request from Japan
 Plate for Switch, Accessories: WTFB6503□-1 / 1G Socket: WTFB6101□-1 / 2G Socket: WTFB6102□-1

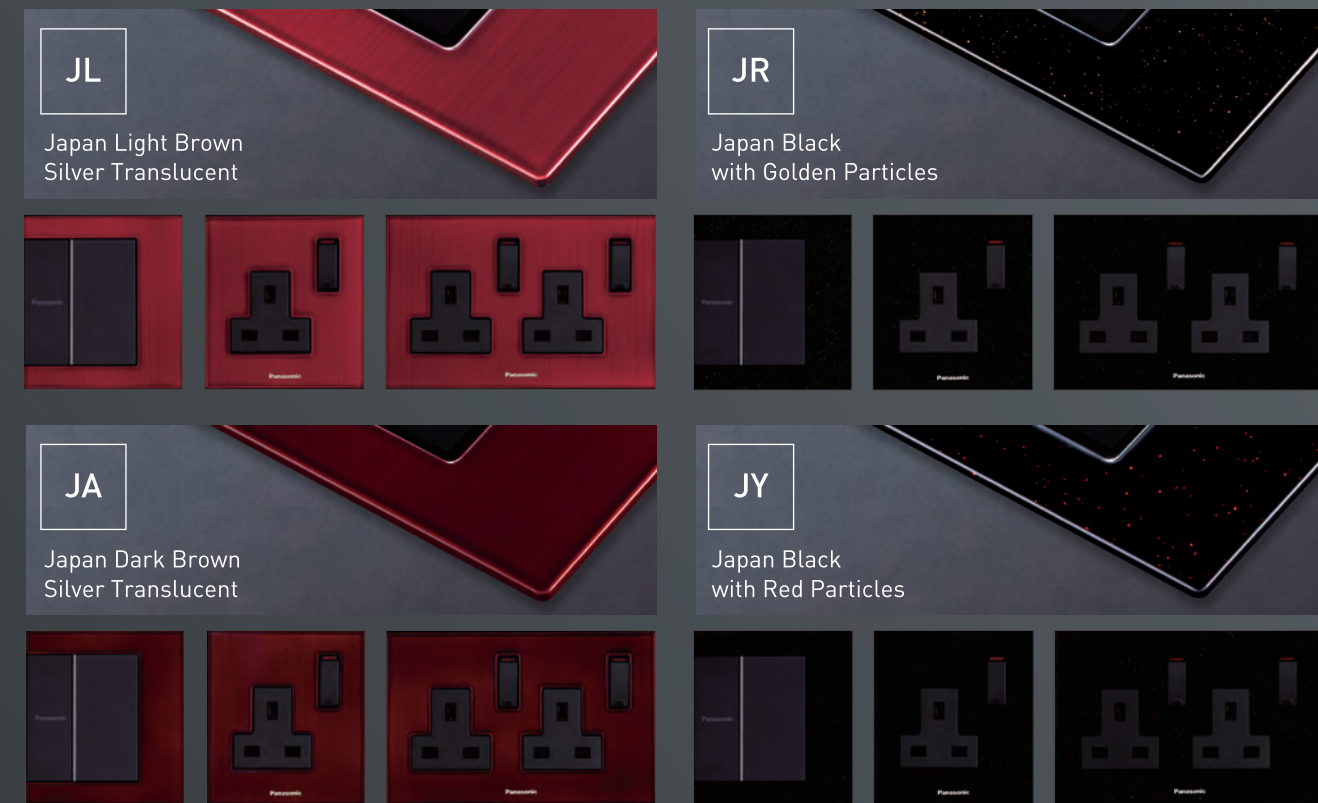

Model No[Plate] *Special order : Made by your request from Japan
 Plate for Switch, Accessories: WTFB6503□-1 / 1G Socket: WTFB6101□-1 / 2G Socket: WTFB6102□-1

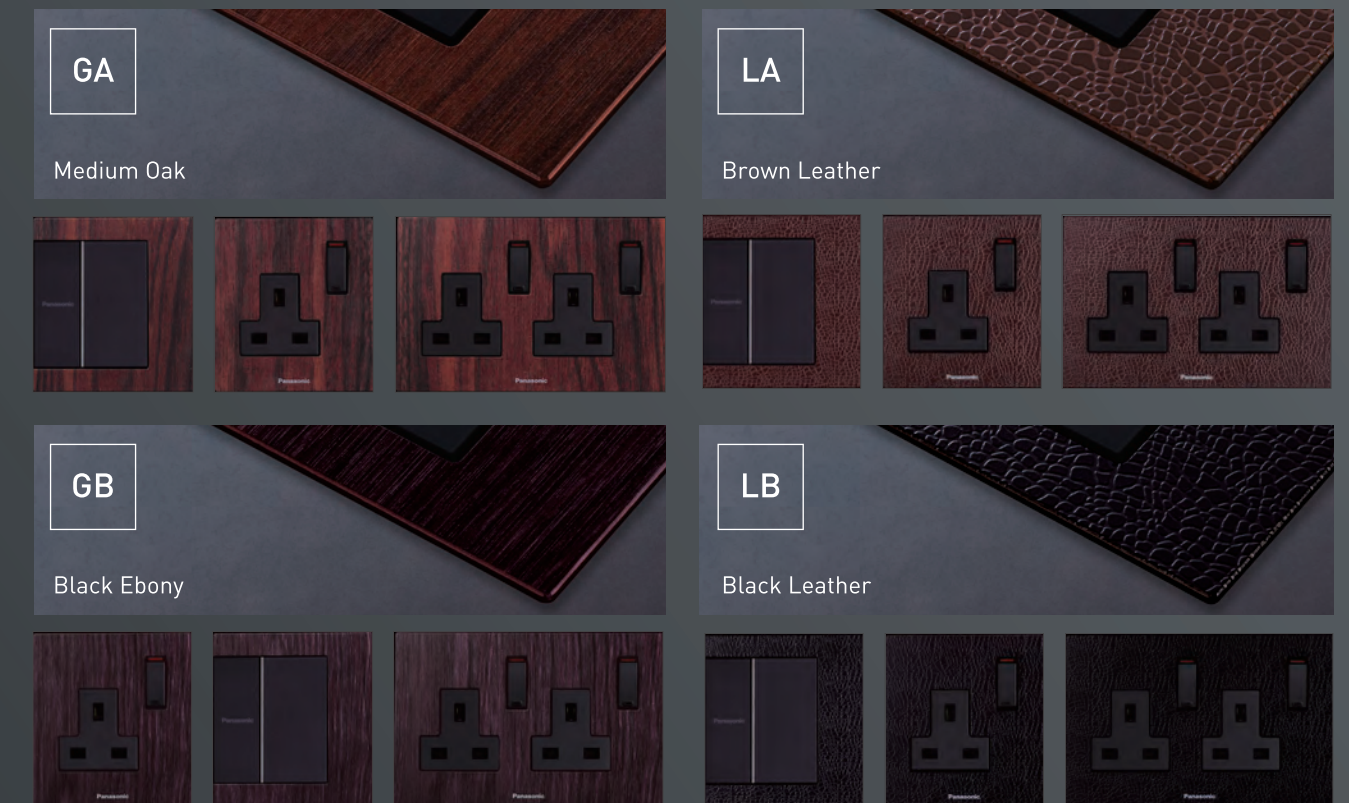

FLATIMA SERIES BS-TYPE

مفاتيح كهربائية Switches

WTFBP51512□-1 1-Gang 2Way Switch 16AX SP Quick Connect Terminal	WTFBP52522□-1 1-Gang 2-Devices 2Way Switch 16AX SP Quick Connect Terminal	WTFBP53532□-1 1-Gang 3-Devices 2Way Switch 16AX SP Quick Connect Terminal	WTFBP5004□-1 1-Gang Intermediate Switch 10AX Quick Connect Terminal
--	--	--	--

WTFBP51559□-1 NEW 1-Gang 2Way Illuminated Switch 16AX SP Quick Connect Terminal	WTFBP52569□-1 NEW 1-Gang 2-Devices 2Way Illuminated Switch 16AX SP Quick Connect Terminal	WTFBP53579□-1 NEW 1-Gang 3-Devices 2Way Illuminated Switch 16AX SP Quick Connect Terminal	WTFBP5411□-1 1-Gang Push Button Quick Connect Terminal
---	---	---	---

ديمر لتحديد شدة الاضاءة Dimmer Switches

WTFBP55137□-1 1-Gang 1Way Switch 20A DP with Indicator	WTFBP5408699□1K 1-Gang 1Way Switch 45A DP with Indicator Pillar Terminal	WTFBP579120□-1 LED Dimmer Switch 200W (LED50W) 220-240V~ 50/60Hz	WTFBP579150□-1 NEW LED Dimmer Switch 240W (LED200W) 220-240V~ 50/60Hz
---	---	---	---

مقابس Socket Outlets

WTFBP11119□-1 1-Gang 13A Switched Socket	WTFBP11129□-1 2-Gang 13A Switched Socket	WTFBP1072□-1 NEW 2-port USB Charger	WTFBP2021□-1 NEW HDMI connector Socket
--	--	--	---



اكسسورات Accessories

WTFBP2501□-1 TV Socket DIN Type	WTFBP2731□-1 TV Socket F Type	WTFBP2164□-1 Telephone Socket 6P4C	WTFBP24886□-1 LAN Socket Cat 6
---	---	--	--

توصيلة اسلاك Cable Outlets

WTFBP7010 Cable Outlet with 20A Terminal	WTFBP7020 Cable Outlet with 45A Terminal
--	--

سلسلة الفنادق Hotel Series

WTFBP52525□-1 NEW Do not Disturb /Please Clean Up Switch	WTFBP53576□-1 NEW Indicators of Do not Disturb and Please Clean Up and Push Switch with Bell Symbol	WTFBP5781□-1 NEW Electric Card Switch 16A 220V AC
--	--	--

الوان متنوعة Variety of Colors

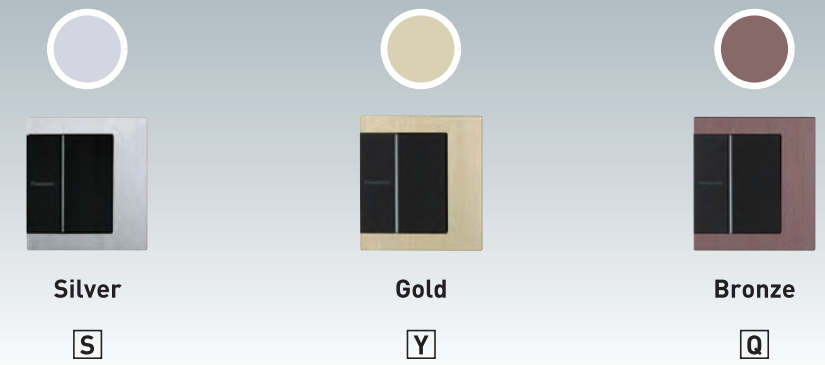

FLATIMA SERIES
BS-TYPE

FULL-COLOR WIDE SERIES
Refina BS-TYPE

FULL-COLOR WIDE SERIES
BS-TYPE

FULL-COLOR SERIES
BS-TYPE

FLATIMA SERIES
BS-TYPE

FULL-COLOR WIDE SERIES
Refina BS-TYPE

FULL-COLOR WIDE SERIES
BS-TYPE

FULL-COLOR SERIES
BS-TYPE

FLATIMA SERIES BS-TYPE

FLATIMA SERIES

مفاتيح كهربائية 10 امبير
Switches 10AX/16AX

BS-TYPE 2way Illuminated Switch		Intermediate Switch	Push Button
WTFBP51512S-1 WTFBP51559S-1	WTFBP51512S-1 WTFBP52569S-1	WTFBP5004S-1	WTFBP5411S-1 *Push On/Off Switches.

Technical Specifications الموصفات الفنية

- Standards: Comply with IEC60669-1
 - Rating: 16AX 250V~ (2way switch), 10AX 250V~ (intermediate, Push button)
 - Ambient Temperature: -10°C - +40°C
 - Representative Performance:
 - Electric strength : 2,000V 1 min
 - Operation test : 40,000 Operations
 - Temperature rise : Test current 22A (2.5 mm²) 17.5A (1.5 mm²) *10AX switch
 - Not more than 45K (Terminals)
 - Terminal: Quick Connect Terminal III (Screwless Terminal)
 - Applicable Wire: 1.5 mm² - 2.5 mm², 14 AWG - 12 AWG
 - Terminal Capacity: 1.5 mm² × 1 14 AWG × 1, 2.5 mm² × 1 12 AWG × 1
- *Supply terminal (2way, Push Button) has 2 terminal holes.

Features المميزات

Screwless Terminal (reduces installation work)

- Quick Connect Terminal significantly reduces connection time, compared to screw terminals. Screw terminal : 10 - 20 seconds, Quick Connect Terminal : 1 second
- Wire connection can be uniformly performed regardless of operator skill level.
- Wires do not loosen even after a long usage. (double contact point structure)

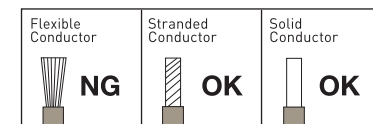

Dimensions الأبعاد

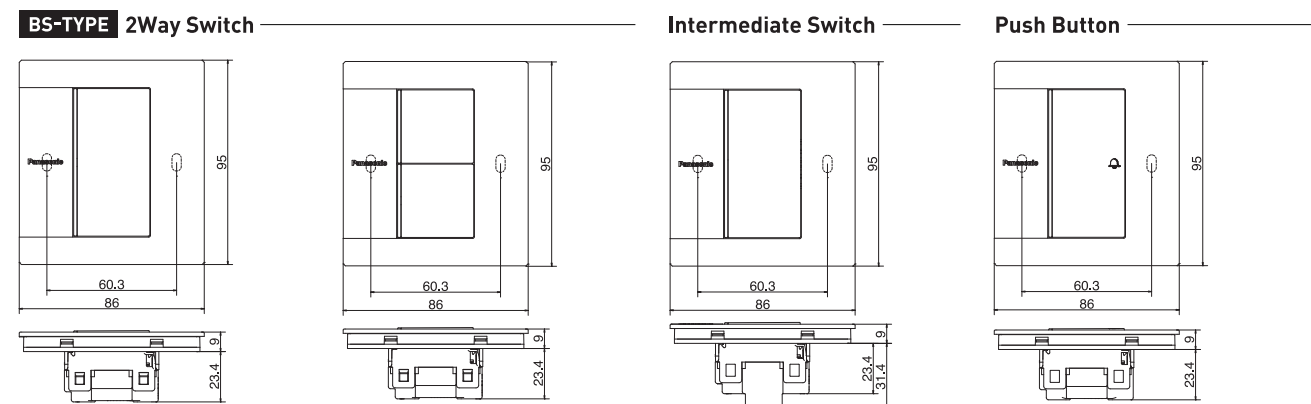

*BS-Type : M3.5 mounting screws included.

Features المميزات

Safety

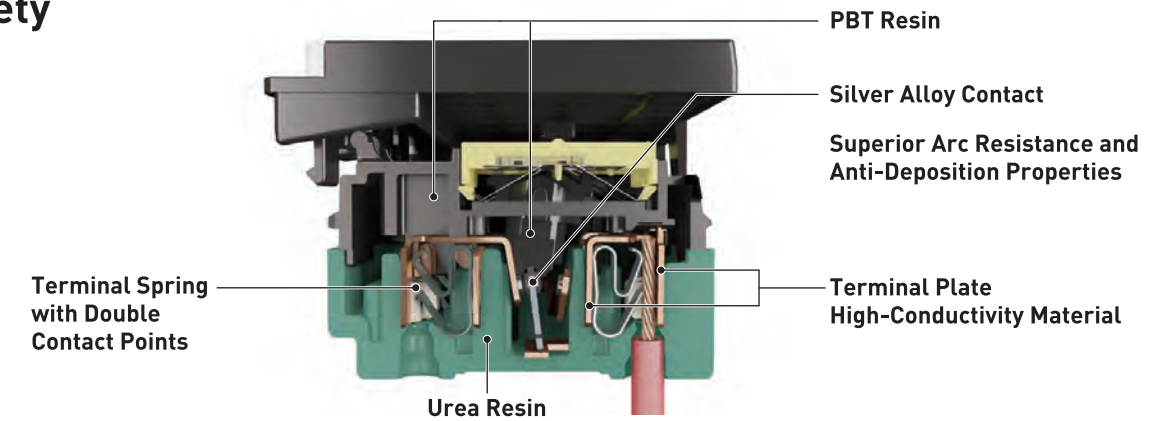

Characteristics of Urea Resin

- Excellent Arc resistance, Arc tracking resistance, Flame retardance, Heat resistance Color fastness.
- Has good electrical performance and mechanical strength with excellent abrasion resistance.
- Difficult to scratch, and there is virtually no adherence of dust due to static electricity.
- Organic solvents and oily substances cannot permeate.

Enclosure Material Characteristics (reference)

	Urea	PBT	Polycarbonate
Tracking Performance	Excellent	Good	Poor
Heat Deformation	Good	Good	Fair
Self-Extinguishment	Good	Good	Good

Easy Operation

- Large control surface requires only a light push to switch On/Off.
- Sliding cam mechanism makes light-push On/Off switching possible.

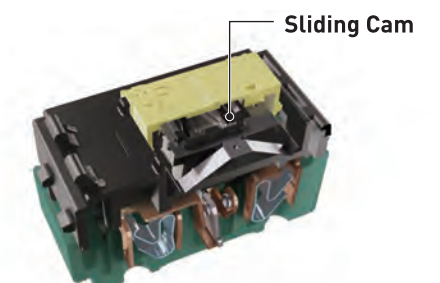

Switch Mechanism

- Panasonic proprietary Push On/Off mechanism used.
- Switch automatically returns to original horizontal position after pushing.

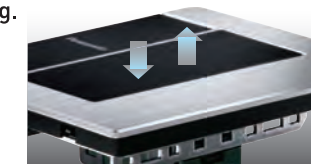

In Case Frame Removed



Dimensions

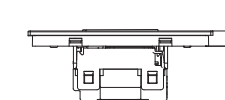

When the frames are removed, they will become flash plate height to 7mm higher and depth of device to 2mm deeper excepting Socket Outlet(1,2-Gang), Dimmer Switch and Cable Outlet(20A, 45A).

FLATIMA SERIES BS-TYPE

FLATIMA
SERIES

مفاتيح كهربائية 20 امبير
Switches 20A

BS-TYPE DP Switch with Indicator



WTFBP55137S-1

FLATIMA SERIES BS-TYPE

FLATIMA
SERIES

مفاتيح كهربائية 45 امبير
Switches 45A

BS-TYPE DP Switch with Indicator



WTFBP5408699S-1*
*Comply BS 3676:1089



WTFBP5408699SK1**
**Comply BS EN 60669-1

Technical Specifications الموصفات الفنية

- ▶ Standards
Comply with IEC60669-1
- ▶ Rating
20A 250V~
- ▶ Ambient Temperature
-10°C – +40°C
- ▶ Representative Performance
 - Electric strength : 2,000V 1 min
 - Operation test : 10,000 Operations
 - Temperature rise : Test current 25A (4 mm²)
Not more than 45K (Terminals)
- ▶ Terminal
Pillar Terminal II
- ▶ Applicable Wire
2.5 mm² - 6 mm²
13 AWG - 10 AWG
- ▶ Terminal Capacity
2.5 mm² × 2
4 mm² × 1
6 mm² × 1

Features المميزات

- High rating silver contact for extended service life.
- Made with flame-retardant and heat-resistant urea resin.
- Conductive section uses heat-resistant copper with superior anticorrosion property and conductivity for long-term stable, reliable performance.
Accepts wires : 2.5 mm² - 6 mm² solid wire and flexible wire.
- Built-in lighted indicator shows On/Off status.

Dimensions الأبعاد

BS-TYPE DP Switch with Indicator

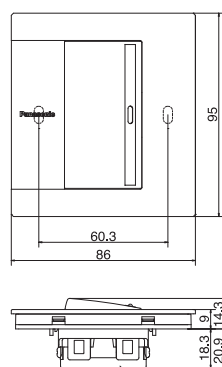

*BS-TYPE : M3.5 mounting screws included.

Technical Specifications الموصفات الفنية

- ▶ Standards
Comply BS EN 60669-1 and BS3676:1089
- ▶ Rating
45A 250V~ (Resistive)
Motor Full load current of 25A or less,
power factor of 0.8 or more)
- ▶ Ambient Temperature
-10°C – +40°C
- ▶ Representative Performance
 - Electric strength : 1,500V 1 min
 - Operation test : 10,000 operations
 - Temperature rise : Test current 51A (16 mm²)
Not more than 45K (Terminals)
- ▶ Terminal
Pillar Terminal
- ▶ Applicable Wire
[Solid] 4 mm²
[Stranded] 4 mm² - 16 mm²
[AWG] AWG 10 - AWG 6
- ▶ Terminal Capacity
4 mm² × 2
6 mm² × 2
10 mm² × 1
16 mm² × 1

Features المميزات

- High-capacity silver contact for longer life.
- Made with flame-retardant and heat-resistant melamine phenol/urea resins.
- Conductive section uses heat-resistant copper with superior anticorrosion property and conductivity for long-term stable, reliable performance.
- Built-in lighted indicator shows On/Off status.
- Normal gap double-pole switch (minimum contact gap : 3 mm) construction ensures safe load shut-off.
- Double Earth Terminal.

Dimensions الأبعاد

BS-TYPE DP Switch with Indicator

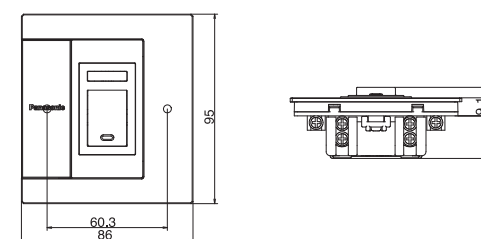

*BS-TYPE : M3.5 mounting screws included.

FLATIMA SERIES BS-TYPE

FLATIMA SERIES

ديمر لتحديد شدة الاضاءة
Dimmer Switches

BS-TYPE LED Dimmer



WTFBP579120S-1
50W



WTFBP579150S-1
200W

Features المميزات

WTFBP579120S-1/WTFBP579150S-1

- Applicable to most LED major bulb brand (We recommend customer to check before purchase).

Minimum Brightness Adjustment Function

WTFBP579150S-1

Minimum brightness can be adjust if the installer found the incident when turn the knob to minimum level

- Bulb is flickering : Increase the lower limit
- Too bright at minimum level : Decrease the lower limit
- Non equally brightness for each bulb : Increase the lower limit

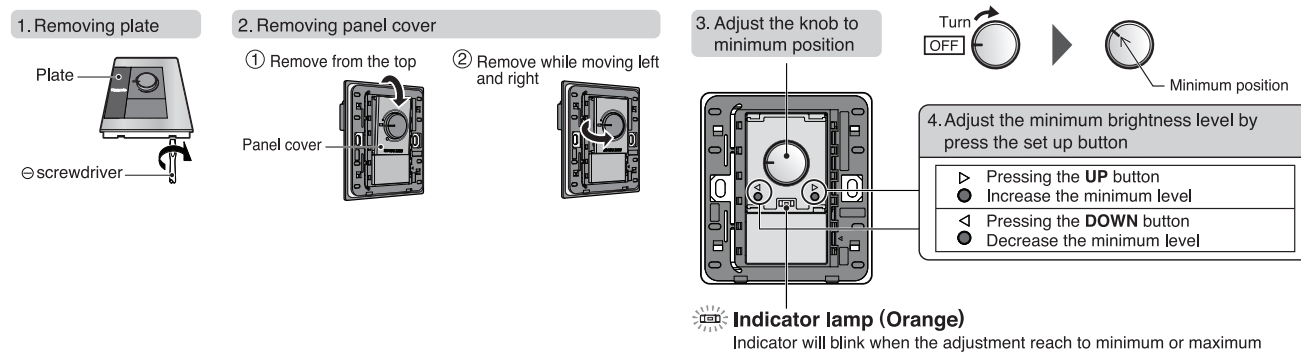

Applicable incandescent lamps & low voltage halogen lamps & LED bulbs

- Chandelier lamp
- Silica lamp
- Clear lamp
- Hi-beam lamp
- Halogen lamp
- LED dimmable bulb

- When using low voltage halogen lamps, requires an applicable transformer to convert voltage from 220 V - 240 V to 12 V.
- The brightness when dimmed is different depending on the LED bulb types and Brand.
- When the knob is lower limit, brightness is different depending on the LED bulb types and Brand.
- Be sure to use a light bulb with a built-in fuse. Not doing so may result in damage to the dimmer switch when the light bulb burns out.

FLATIMA SERIES BS-TYPE

FLATIMA SERIES

مقابس
Socket Outlets

BS-TYPE Switched Socket



WTFBP1111S-1*
*Comply only IEC60884-2-3



WTFBP11119S-1



WTFBP1112S-1*
Comply only IEC60884-2-3

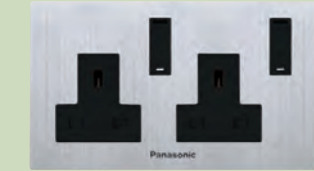

WTFBP11129S-1

Technical Specifications الموصفات الفنية

- ▶ Standards
Comply with IEC60884-2-3 and BS1363-2
- ▶ Rating
13A 250V~
- ▶ Ambient Temperature
-10°C – +40°C
- ▶ Representative Performance
·Electric strength : 2,000V 1 min
·Operation test : 15,000 times (30,000 movements)
·Temperature rise : Test current 20A (2,5 mm²)
Not more than 52K (Terminals)
- ▶ Terminal
Pillar Terminal II
- ▶ Applicable Wire
1.5 mm² - 4 mm²
15 AWG - 12 AWG
- ▶ Terminal Capacity
1.5 mm² × 3
2.5 mm² × 3
4 mm² × 2

Features المميزات

- Socket Outlet with a double-pole switch completely isolates load from power supply.
- Socket Outlet housing uses flame-retardant and heat-resistant urea resin with high anti-tracking properties.
- Accepts wires : 1.5 mm² - 4 mm² solid wire and flexible wire.
- Both socket and switch components have adequate switching capability.
- Included safety shutter prevents kids from tampering with switch.

Dimensions الأبعاد

BS-TYPE Switched Socket

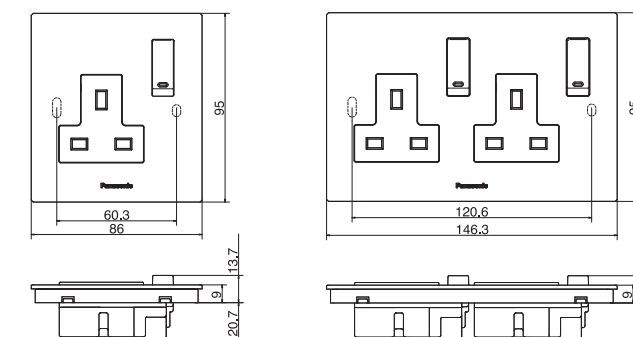

*BS-TYPE : M3.5 mounting screws included.

Applicable Box العلبة المناسبة

BS-TYPE



- ▶ Dimensions
Plate : 95 x 86 mm
Box : 72 x 72 mm
Fixing Center : 60.3 mm

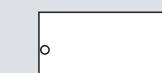

- ▶ Dimensions
Plate : 95 x 146.3 mm
Box : 72 x 132 mm
Fixing Center : 120.6 mm

FLATIMA SERIES BS-TYPE

FLATIMA SERIES

اكسسورات TV Accessories - Television

BS-TYPE DIN Type



WTFBP2501S-1

F Type



WTFBP2731S-1

Technical specifications الموصفات الفنية

WTFBP2501S-1

- ▶ Connector Type (Outlet) : DIN Type
- ▶ Terminal
Screw Terminal
(Only coaxial core isn't screw terminal type)
- ▶ Impedance Input, Outlet : 75Ω
- ▶ Applicable Cable
Coaxial Cable
Characteristic Impedance 75Ω type : 5C-2V, 3C-2V

WTFBP2731S-1

- ▶ Connector Type (Outlet) : F Type
- ▶ Terminal
Screw Terminal
(Only coaxial core isn't screw terminal type)
- ▶ Impedance Input, Outlet : 75Ω
- ▶ Applicable Cable
Coaxial Cable
Characteristic Impedance 75Ω type : S-5C-FB

Features المميزات

"Easy Connect" terminal for direct insertion of coaxial cable core.

Insert fully and tighten clamp.

WTFBP2501S-1

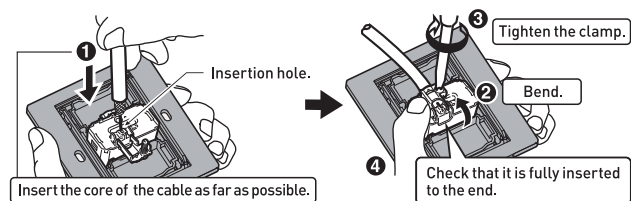
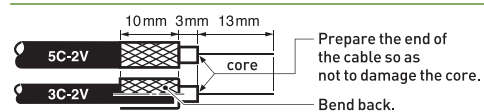

WTFBP2731S-1

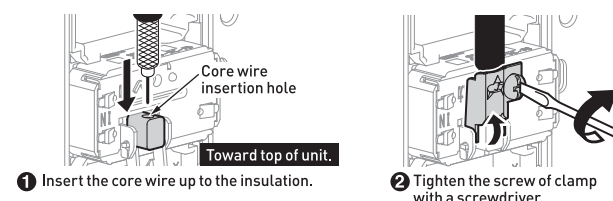
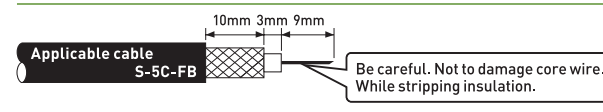

Dimensions الأبعاد

BS-TYPE DIN Type

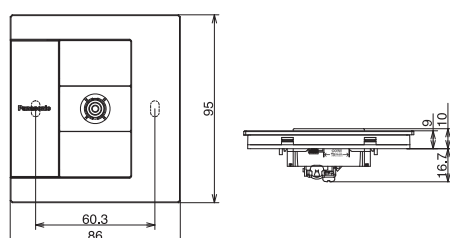

*BS-TYPE : M3.5 mounting screws included.

F Type

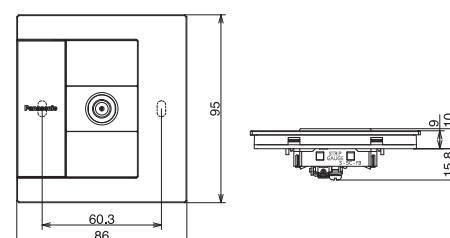

FLATIMA SERIES BS-TYPE

FLATIMA SERIES

اكسسورات هاتف Accessories - Telephone

BS-TYPE 6P4C



WTFBP2164S-1

اكسسورات خط انترنت Accessories - LAN

BS-TYPE Category 6



WTFBP24886S-1

Technical Specifications الموصفات الفنية

- ▶ Connector Type
Miniature Modular Jack, 6 position with 4-contacts, specified in TIA-1096-A (Previously in FCC part 68)
- ▶ Terminal
Quick Connect Terminal (Screwless Connection)
- ▶ Applicable Wire
Paired quad-type PVC indoor cable : Core wire to be 0.4 mm, 0.5 mm, 0.65 mm, in diameter (solid copper only)
2-pair Business-phone indoor cable : Core wire to be 0.4 mm, 0.5 mm, 0.65 mm, in diameter (solid copper only)

- ▶ Connector Type
"8-way unshielded fixed connector (miniature 8-position modular jack)" specified in IEC 60603-7
- ▶ Terminal
IDC connection
- ▶ Applicable Wire
4-pair UTP cable, Category 6
Conductor : Solid copper wire, 24 AWG - 22 AWG (diameter : 0.5 mm-0.65 mm)

Features المميزات

Telephone

- Simple Connection
Just insert cable into the terminal hole.
- Easy Cable Disconnection
Push removal button while pulling out cable.

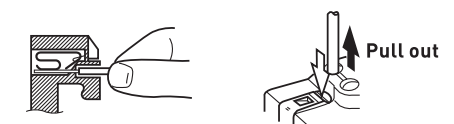

LAN

- 1 It's not necessary to use special wiring tool.
- 2 No need to untwist the wires.

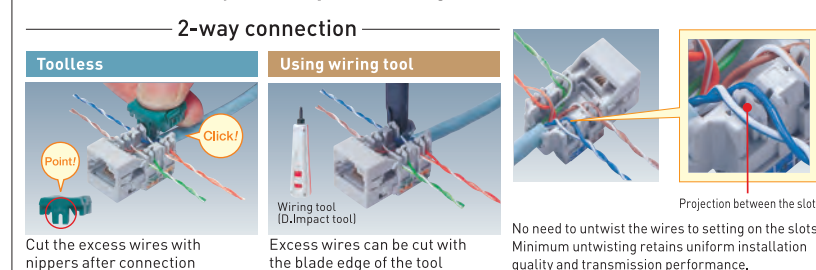

Pin/Pair assignment

Pair	Color	Pin No.	
		T568A	T568B (Optional)
1	W/BL	5	5
	BL	4	4
2	W/O	3	1
	O	6	2
3	W/G	1	3
	G	2	6
4	W/BR	7	7
	BR	8	8

Dimensions الأبعاد

BS-TYPE 6P4C

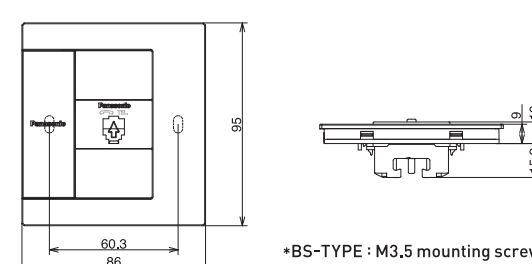

*BS-TYPE : M3.5 mounting screws included.

BS-TYPE Category 6

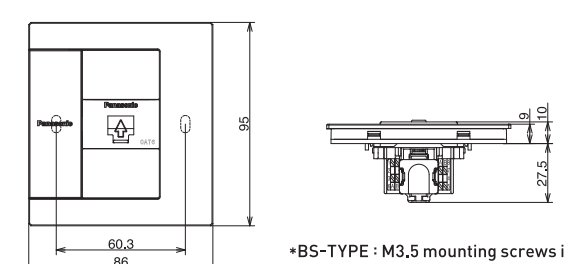

*BS-TYPE : M3.5 mounting screws included.

FLATIMA SERIES BS-TYPE

FLATIMA SERIES

سلسلة الفنادق
Hotel Series

Do not Disturb and Please Clean Up switch and indicator

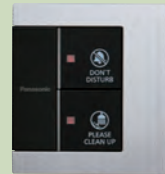

WTFBP52525-1

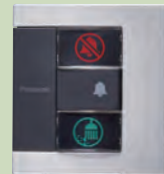

WTFBP53576-1

Electric card switch



WTFBP5781-1

FLATIMA SERIES BS-TYPE

اخرى
Others

HDMI connector



WTFBP2021S-1

الموصفات الفنية Technical Specifications

► Applicable Wire
HDMI cable : Type A

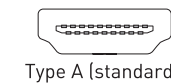

Type A (standard)

► Wiring Method

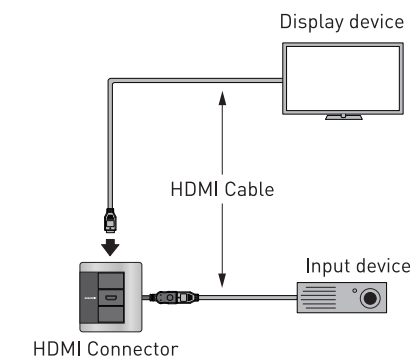

المميزات Features

Wiring Diagrams

DND and PCU Switch & Indicator

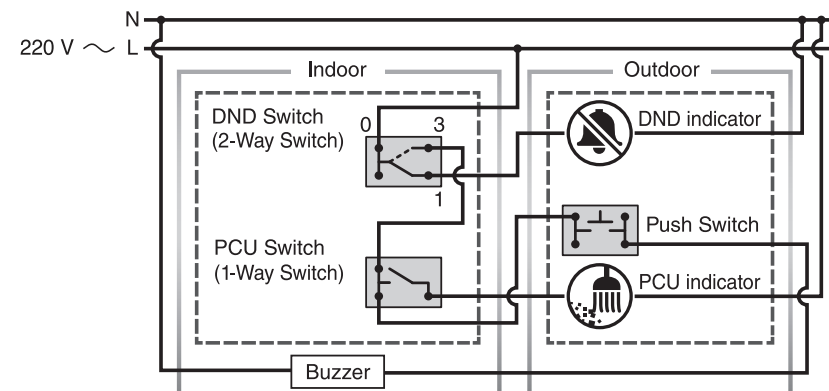

DND: DON'T DISTURB PCU: PLEASE CLEAN UP

The "DND" and "PCU" indicator can not be lit at the same time.
Only "DND" indicator will lights up even though both switches are ON.
Please turn "DND" switch to OFF mode in order to light up "PCU" indicator.

Electric Card Switch

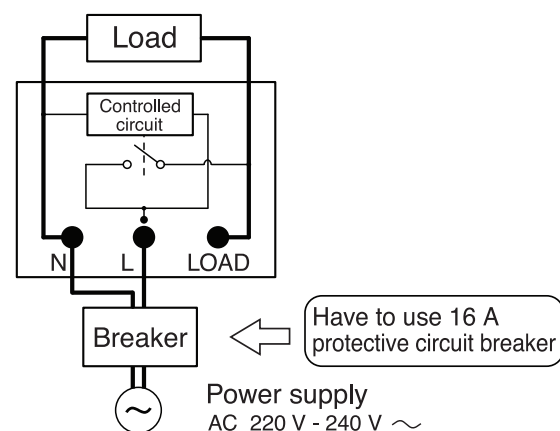

Power supply
AC 220 V - 240 V ~

2-port USB Charger



WTFBP1072S-1

الموصفات الفنية Technical Specifications

► Standards
Comply with
USB: IEC 60950-1

► Rating
USB Charger : DC 5V 2.0A

► Ambient Temperature
-10°C - +40°C

► Representative Performance

· Operation test :
USB Charger : 10,000 times
· Temperature rise : Test current 20A (2.5mm²)
Not more than 52K (Terminals)

► Terminal
Quick connect Terminal II

► Applicable Wire
1.5 mm² - 2.5 mm²
14AWG - 12AWG - 2.25mm

► Terminal Capacity
1.5 mm² x 1
2.5 mm² x 1
14 AWG x 1
12 AWG x 1